

XTOOL

Suporte para o chão da caixa self-service

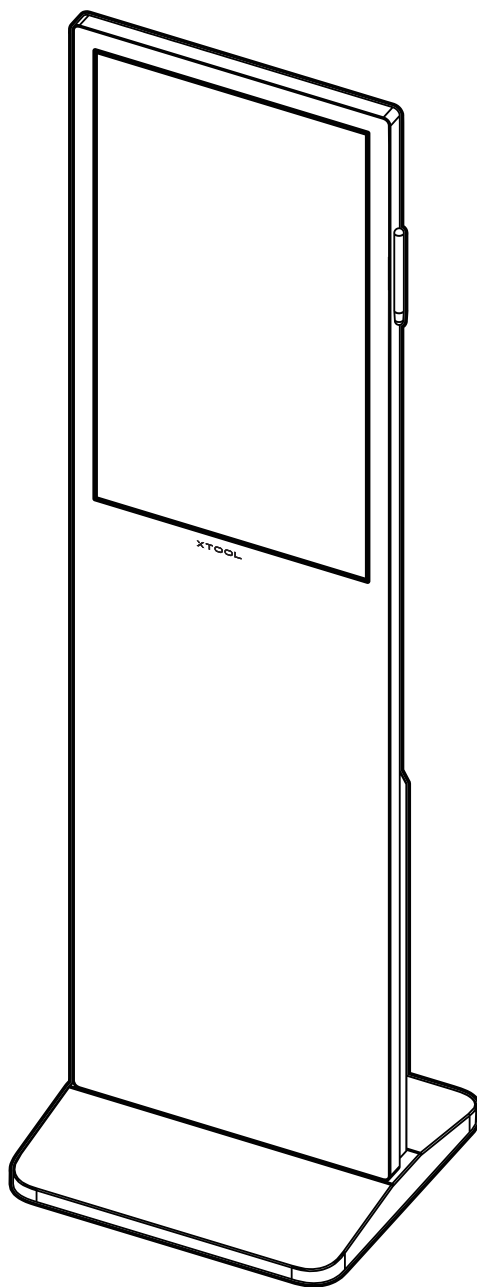

Manual de referência rápida

Lista de itens ----- 01

Visão geral do suporte para o chão da caixa self-service xTool ----- 02

Instalar o suporte para o chão da caixa self-service xTool ----- 04

Utilizar o suporte para o chão da caixa self-service xTool ----- 06

Lista de itens

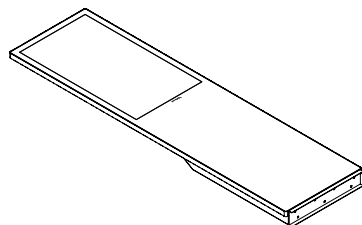

Caixa self-service

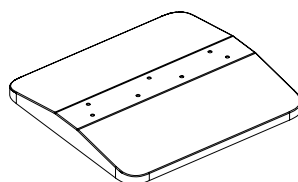

Base de suporte

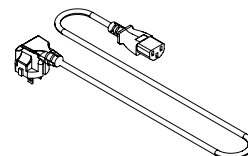

Cabo de alimentação

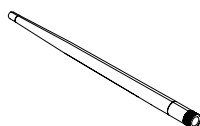

Antena

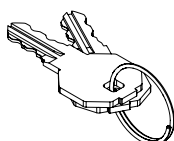

Chave de manutenção

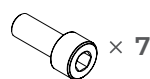

Parafusos

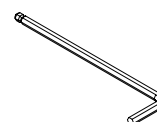

Chave sextavada

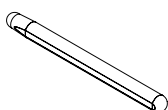

Estilete

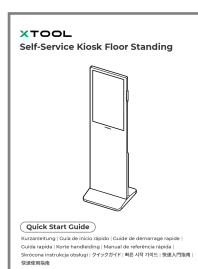

Manual de referência rápida

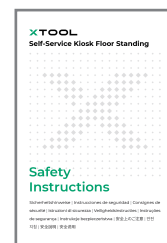

Instruções de segurança



O cabo de alimentação varia de acordo com a região para a qual o produto é fornecido.

Visão geral do suporte para o chão da caixa self-service xTool

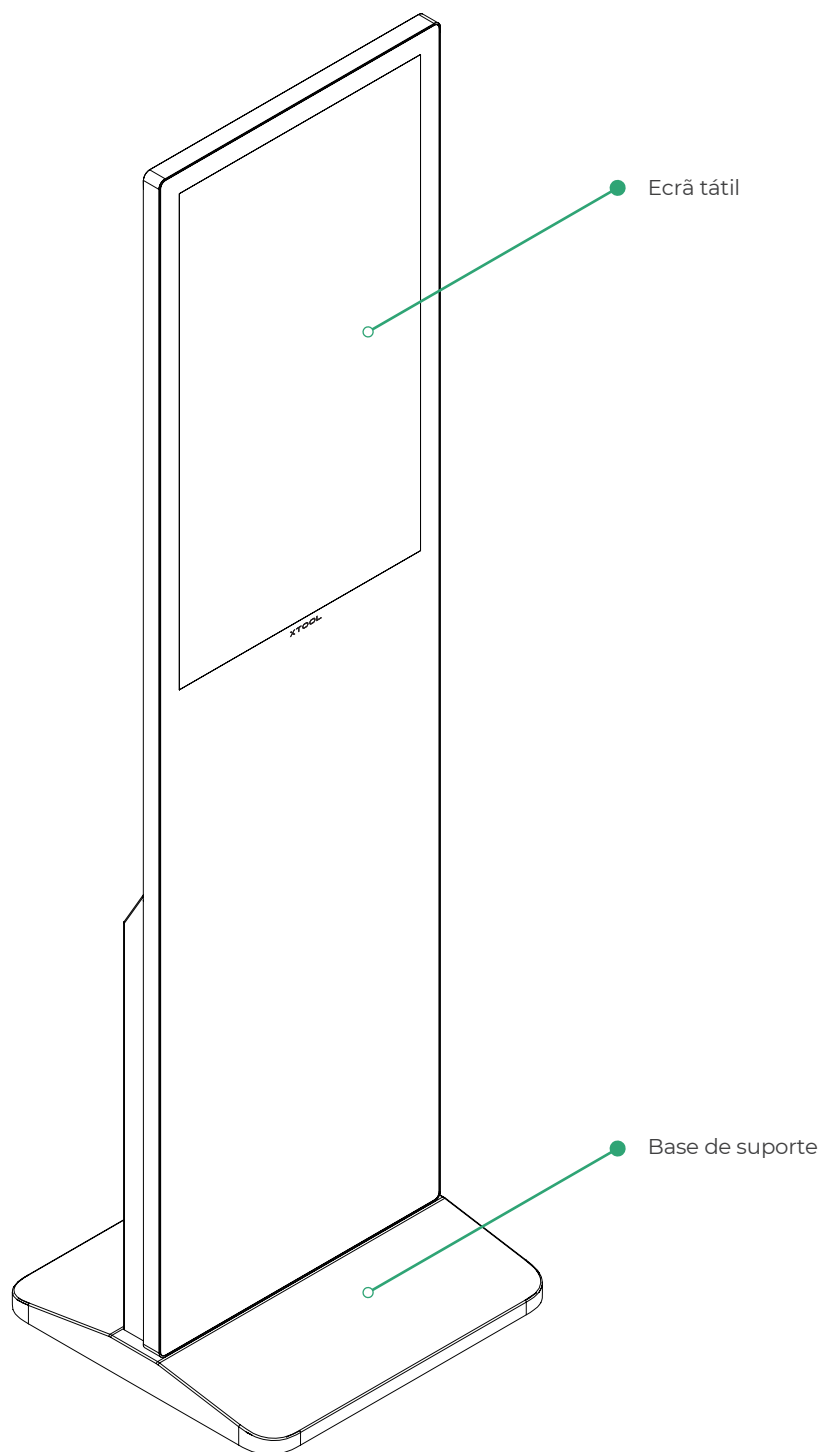

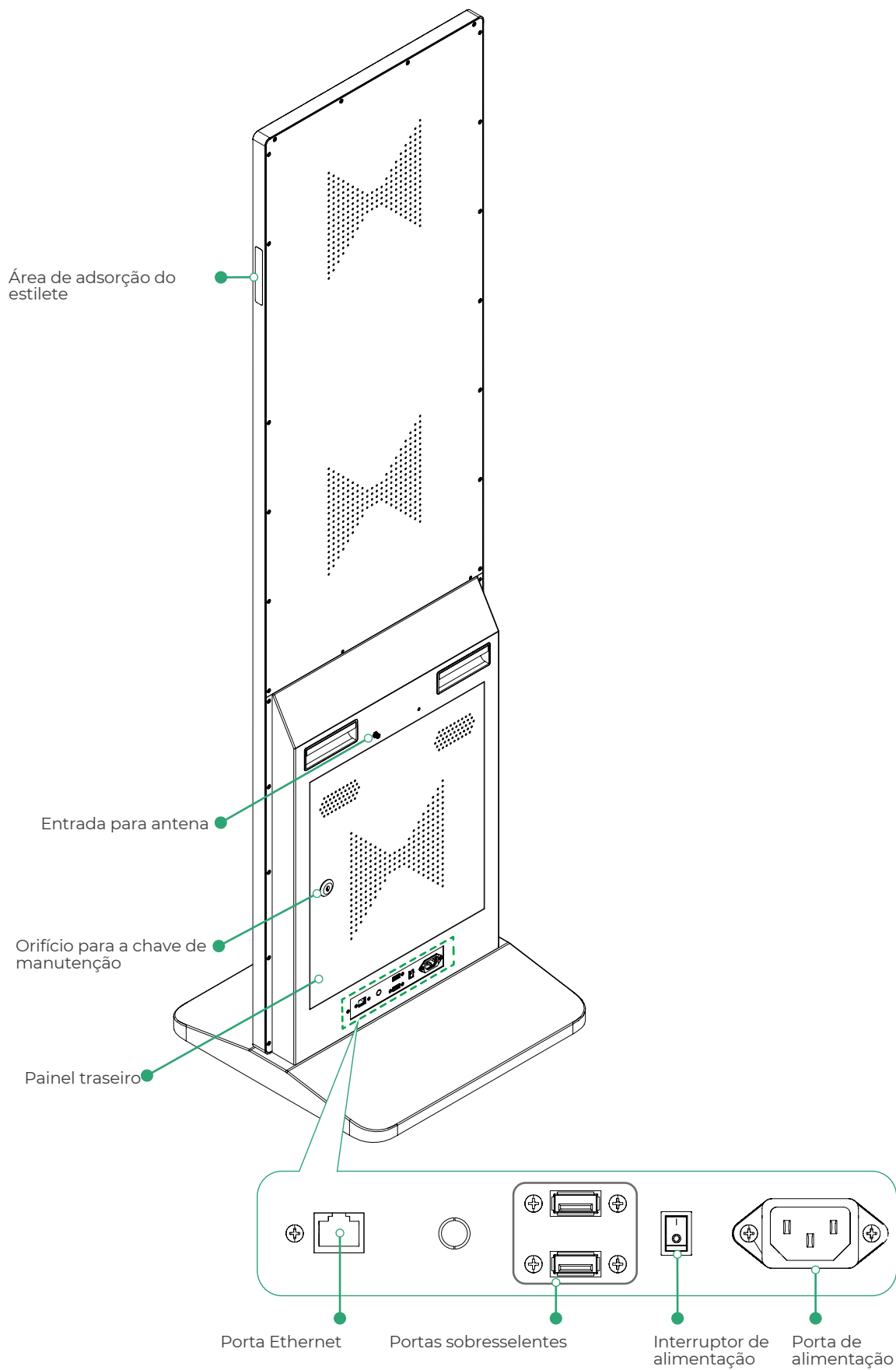



 O painel traseiro só abre com a chave de manutenção, durante a reparação.

Instalar o suporte para o chão da caixa self-service xTool

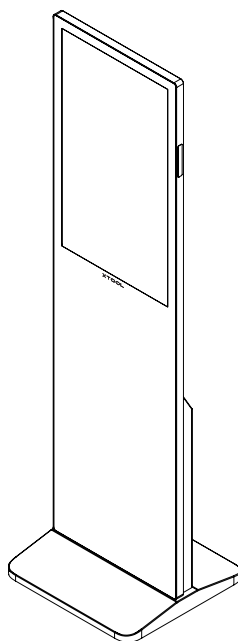
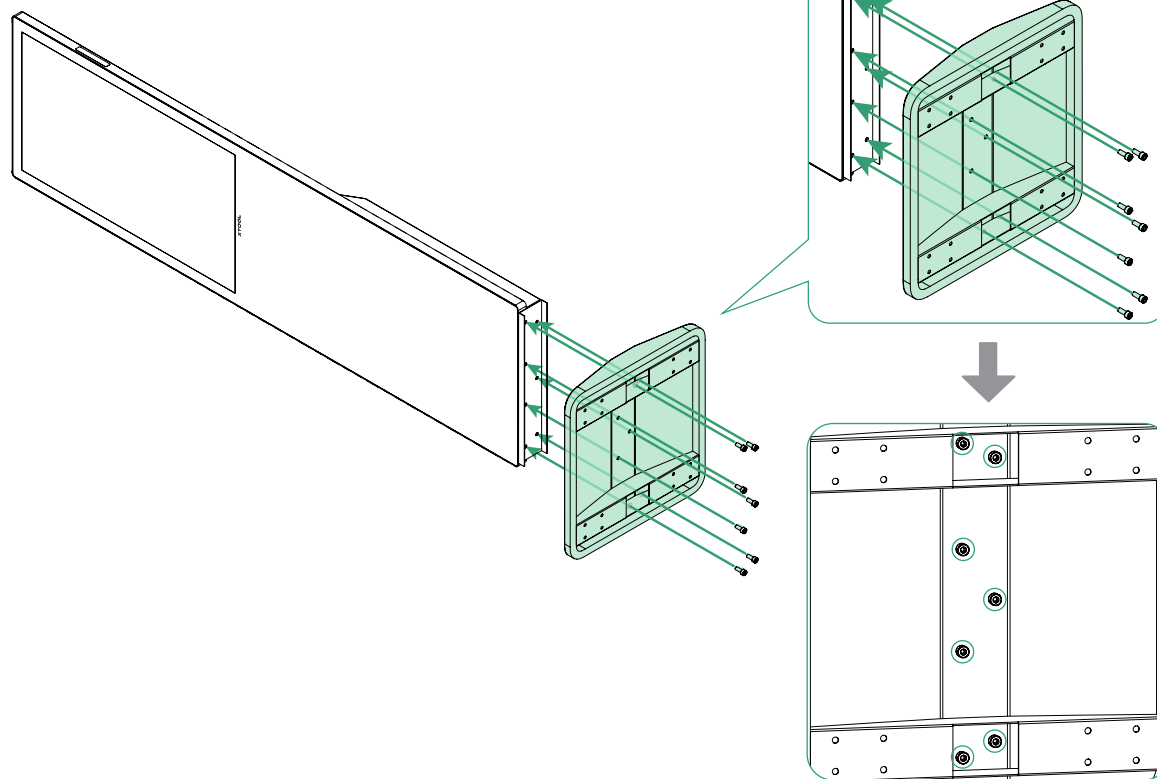
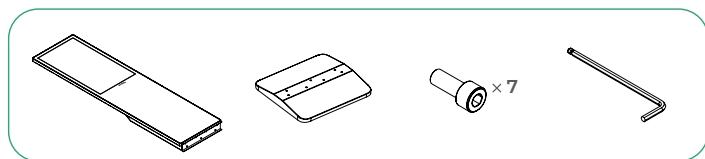
1 Instalar a base de suporte

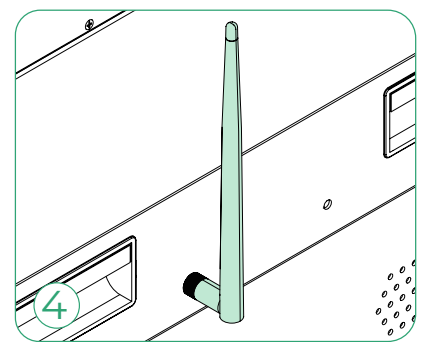
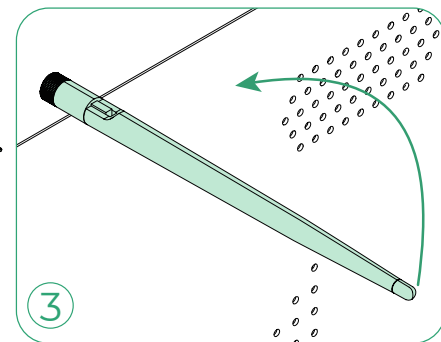
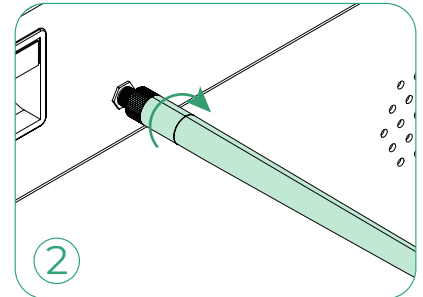
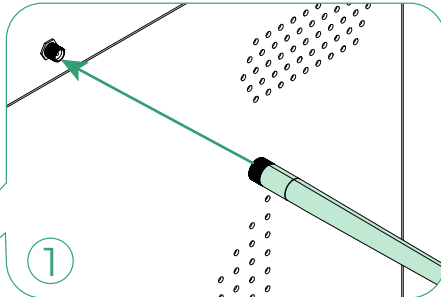
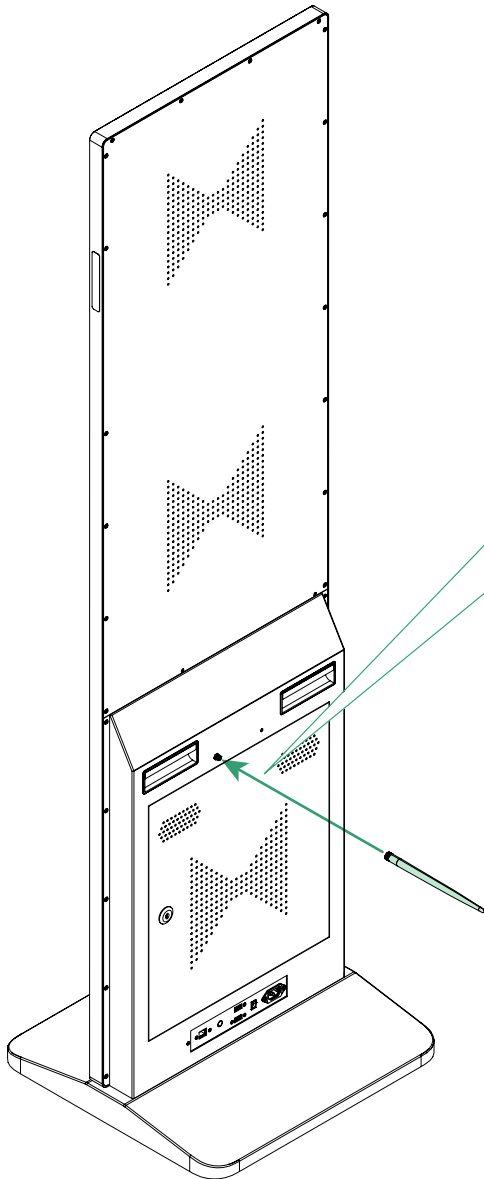
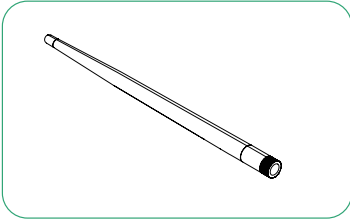

2 Instalar a antena



Utilizar o suporte para o chão da caixa self-service xTool

Insira o cabo de alimentação e ligue a caixa

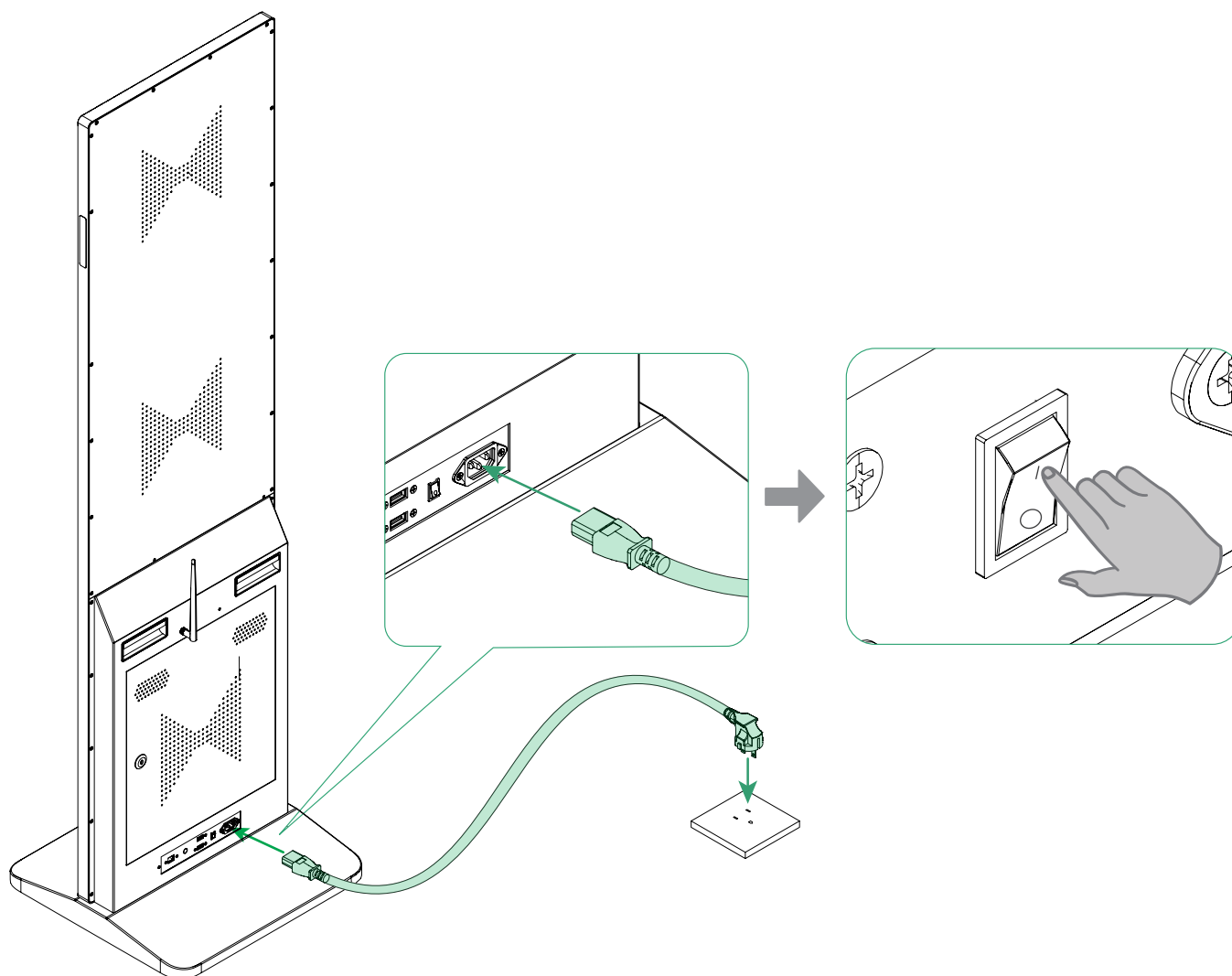
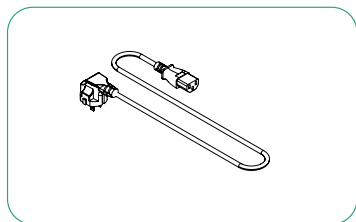

Leia o código QR ou consulte o website para aprender a utilizar o produto com máquinas xTool para processamento.



support.xtool.com/article/2087

XTOOL